



## Custom Dust Collection Booths

Fugitive dust, smoke and fumes are removed from the open production area and contained within the booth. The Enviro-Cell eliminates the need for central dust safe working environment. Housekeeping is restricted to the interior of the booth. The work area is continuously cleaned by cartridge filters offering filtration capabilities of 99.8% efficiency down to 0.5 microns. Air discharge is recirculated back into the environment. Knocked down Booth Panels are custom designed to meet customer specifications.

### Standard Features

- **All Welded Heavy Sheet Steel**
  - 12 Gauge Steel will stand up to years of daily abuse
- **Filter Racking System**
  - Provides a tight and even seal between the filter and fan assembly
- **Auto Reverse Pulse Filter Cleaning**
  - Compressed air manifold delivers a pulse of air to clean the filters
- **Dust Drawers**
  - Easily remove dust from the bottom of the dust collector located on the booth side.
- **Urethane Mastic External Coating**
  - Durethane DTM by PPG chemically resistant and extremely durable. Provides excellent corrosion resistance with superior color and gloss retention.
- **Custom Booth Sizes**
  - Booths are custom built to the needs of the customer and can be constructed of various materials, sound insulation and crane slots.

### HIGHLIGHTS

#### PULSE FILTER CLEANING

The compressed air manifold for filter blowdown is nested inside the unit for convenient system installation against an existing wall or corner. Pulse Controls are standard, complete with Photohelic Gauge monitoring, and supplied with a timer in a NEMA 12 control box. Motor controls, if supplied, are housed in the same control box for ease of connection. Custom capacities are also available.

#### MAINTENANCE ACCESS

The aluminum louvered front access panels remove easily for access to the filter chamber. Additionally, the dust drawer is accessible under the aluminum panels from the booth side of the dust collector for simple dust removal.



## Popular Options

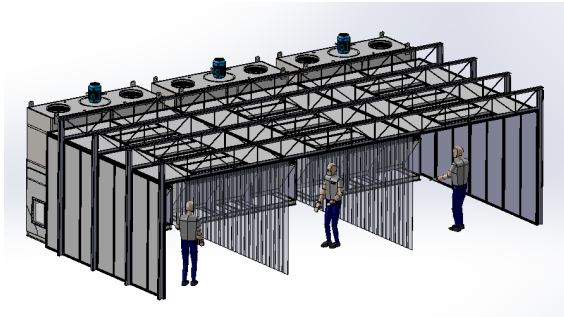

Custom enclosures designed for your specific application / workflow.

Custom flush mounted lighting for a bright and safe work zone.

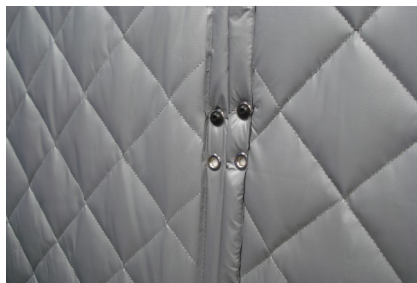

Sound insulated panels

Custom crane slots available to easily transport heavy material into the booth area.



All ProVent equipment is available in painted or unpainted stainless steel. Popular with the food processing industry, stainless steel provides cleanliness and longevity to the equipment.

ProVent Silencers reduce the noise level produced by the exhausted air. ProVent manufactures silencers that are perfectly matched to the collectors they serve.



## Specifications

Model	EWC-4	EWC-6	EWC-8	EWC-10	EWC-12	EWC-16
Air Flow	4,000	6,000	8,000	10,000	12,000	16,000
Static Pressure (in. Wg)	3	3	3	3	3	3
Dry Weight (lbs)	1,800	2,800	3,000	3,500	3,800	4,200
TEFC Motor, HP	3	5	10	15	15	20
Motor Full Load Amps	4.8	7.6	14	21	21	27
Motor / Fan RPM	1750	1750	1750	1750	1750	1750
Primary Voltage	460 Volt 3 Phase 60 Hertz					
Fan Size	182 BC, 100%	200 BC 100%	245 BC, 63%	270 BC, 56%	270 BC, 56%	270 BC, 89%
Fan Type	AMCA Rated, Backward Curved, Single Width, Mild Steel					
Housing Construction	12,10 Gauge and 3/16", Solid Welded					
Motor Controls	NEMA 12 Start / Stop with Overload Protection					
Filter Media Square Foot	1080	1825	2725	3650	3650	5475
Filter Media / Cartridge	NANO Web Fire Retardant					
Filter Cartridge	(6x) 26" L W/ 14 x 16" Top Flange	(5x) 52" L W/ 14 x 16" Top Flange	(5x) 52" L W/ 14 x 16" Top Flange	(10x) 52" L W/ 14 x 16" Top Flange	(10x) 52" L W/ 14 x 16" Top Flange	(10x) 52" L W/ 14 x 16" Top Flange
Filter Cleaning	(1) Digital Sequencer / Timer with Internal DP Switch for On-Demand and Off-Line Pulse Cleaning. Includes Digital DP gauge; (2x) 1" Diaphragm Valves.					
Compressed Air	80-90 PSI Required Hook-Up; 1/2" NPT Coupling					
Clean-Out Drawer Dim.	(2x) 23" W x 30" D x 6" T	(4x) 18" W x 30" D x 6" T	(4x) 22" W x 39" D x 6" T	(4x) 22" W x 39" D x 6" T	(4x) 22" W x 39" D x 6" T	(4x) 2" W x 55" D x 6" T
External Coating	Durethane DTM by PPG is a Direct-To-Metal Urethane Mastic Coating that is Chemically Resistant and Extremely Durable. It Provides Excellent Corrosion Resistance and has Superior Color and Gloss Retention, Excellent Adhesion, UV Protection, and is Abrasion Resistant.					